



Three dimensional kits

Free Download Kit
Instructions
www.3dk.ca

Unauthorized distribution, copying, commercial exploitation or modification by the purchaser or any third party of this 3DK© publication is strictly prohibited without the owners permission. March 2011

Assembly

Cut the building from the sheet using a hobby knife or scissors. If using a hobby knife, be sure to use a straight edge for a clean accurate cut. Colour the "white" edges of each cut using a marker or paint. Be careful not to get paint or marker on the front of the sheet by colouring the cut edge from behind with the tip pointing toward the front.

Suggested Uses:

Cut and place directly on backdrop.
Glue to foam board or cardstock and mount in front of backdrop.
Cut out extra sides and fix in place to form a 3-sided building
Individual buildings can be cut and rearranged to fit your layout.
Layer buildings to force perspective and add more depth.
Smaller scale buildings imply greater depth.

If you are going to fix your sheets to cardstock or mounting board (foam core, wood, etc), test fit the sheets to them and secure the support pieces to a base. Allow for overlap at the corners. The base can be foam board, wood or other rigid sheet material.

For more information on the range of kits available, please visit my web site at: www.3dk.ca

Also, I would very much like to hear how you used the kit on your layout with a few lines and some images. Just send to h3dk@live.ca

Thank you

Calum Faeroin-Cruich March 2011

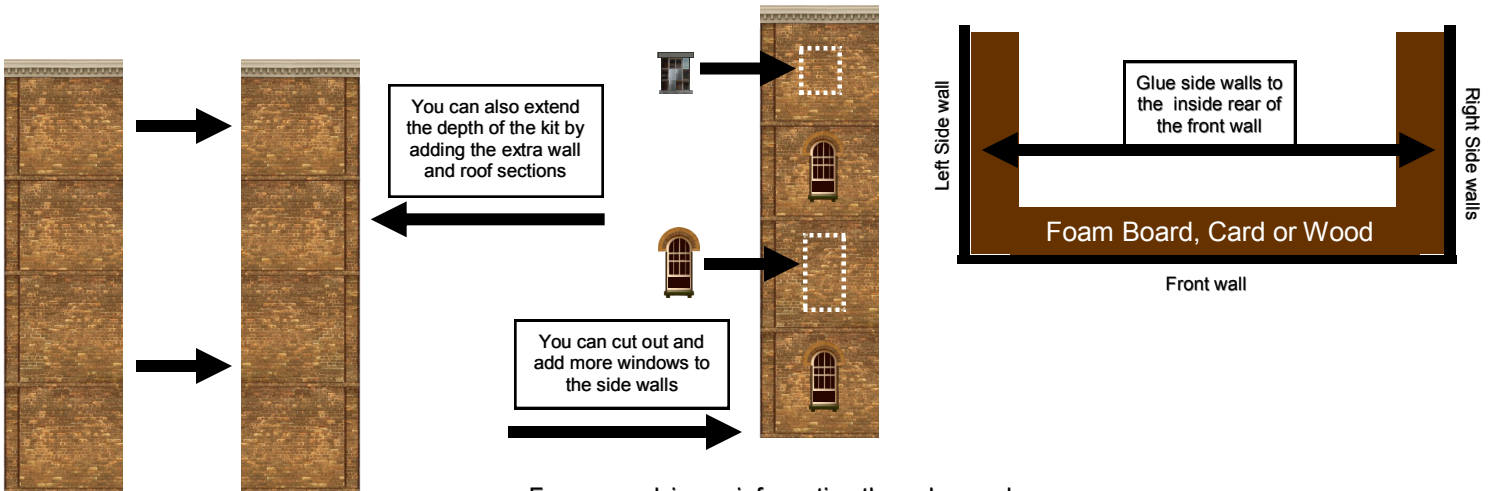
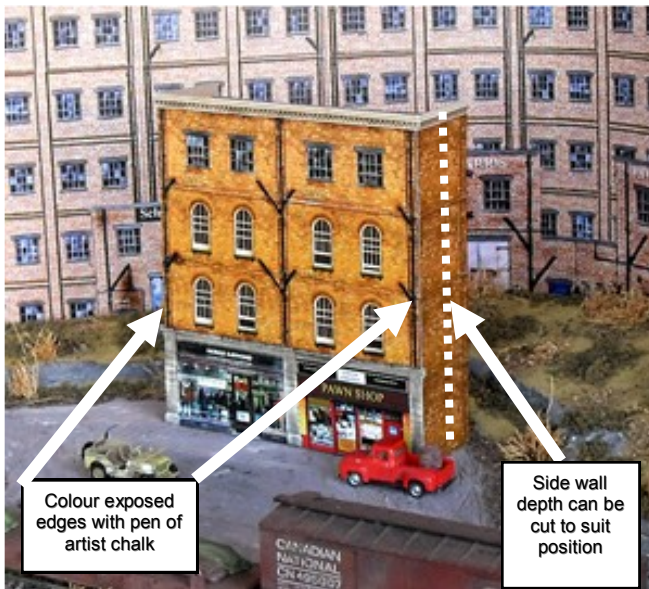

For more advice or information then please phone 905 538 6755 or email: h3dk@live.ca

Visit www.3dk.ca for online advice and help guides